

Alpha[®] 5" Electric Wet/Dry Stone Cutter Instruction Manual

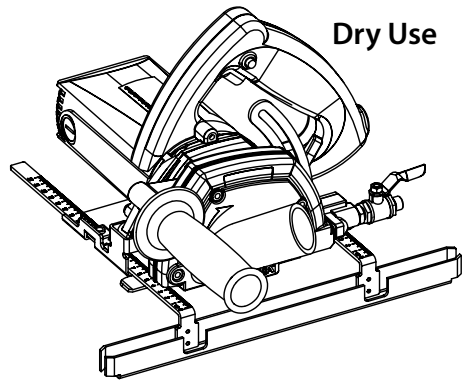
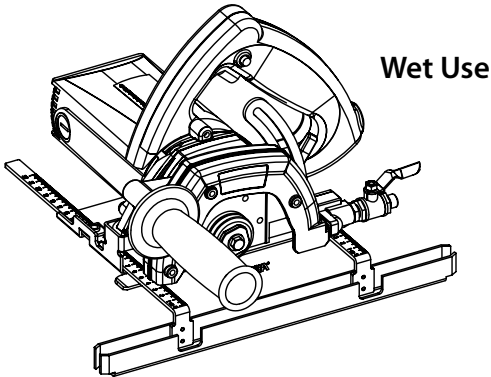

**Part No: ESC-225
Version 1**

 **Alpha Professional Tools**[®]

103 Bauer Drive, Oakland, NJ 07436 • 800-648-7229 • Fax: 800-286-0114
www.alpha-tools.com

TABLE OF CONTENTS

Introduction.....	3
About Symbols	3
Electrical Symbols.....	3
Safety instructions	4
For Safe Operation.....	4
ESC-225 Overview	6
Equipment Included	7
Additional Precautions for Using the Wet/Dry Stone Cutter	8
ESC-225 Wet/Dry Stone Cutter Operation	9
Main Connection	9
Switching ON and OFF	9
Ground Fault Circuit Interrupter	10
Before Use.....	11
About Double Insulation	12
Laws and Regulations of Noise Levels	12
Instructions for Installing the Felt Strips	12
Installation of Water Hose Assembly (Wet Use).....	13
Supplying the Water Flow	13
Installation of Quick Connect Adapter	14
Installation of EasyOn-EasyOff Sleeve	14
Adjusting the Cutting Depth	15
Mounting and Dismounting Saw Blade	15
Straight Cutting Blade Installation (Wet Use).....	16
Curve Cutting Blade Installation (Wet Use).....	16
Attaching the Dust Cover (Dry Use).....	17
Attaching the Vacuum Hose (Dry Use).....	17
Free-Hand Cutting.....	18
Cutting Using TT Ruler Guide	18
Cutting Using the Carriage Assembly and Guide Rail (Wet & Dry Use).....	19
Curve Cutting Application.....	19
Blade Inspection, Installation and Removal.....	20
ESC-225 Maintenance	21
Replacing and Checking the Carbon Brushes.....	22
ESC-225 Wet/Dry Stone Cutter Schematic.....	23
ESC-225 Wet/Dry Stone Cutter Parts List.....	24
EC Declaration of Conformity	26
Warranty	26
Product Registration Card	27

INTRODUCTION

Thank you for purchasing the Alpha® ESC-225 Electric Wet/Dry Stone Cutter. Please read this instruction manual thoroughly to ensure safe and correct use of the wet stone cutter. Keep this manual in a place where operators can access it easily whenever necessary.

► ABOUT THE SYMBOLS

According to the hazard level, all safety notes in this manual are classified into “DANGER”, “WARNING”, and “CAUTION”.

 **DANGER!** Death or serious personal injury is imminent when handling this electric wet/dry stone cutter incorrectly.

 **WARNING!** There is a possibility of death or serious personal injury when handling this electric wet/dry stone cutter incorrectly.

 **CAUTION!** There is a possibility of personal injury or property damage when handling this electric wet/dry stone cutter incorrectly.

NOTE: In some situations, failing to observe WARNING notes could result in death or serious personal injury. Be sure to read and observe the safety notes to ensure safety and correct use of the electric wet/dry stone cutter.

► ELECTRICAL SYMBOLS

The following show the symbols used for tool.

V	Volts
A	Amperes
Hz	Hertz
~ or a.c.	Alternating Current
n0	No load speed
.../min	Revolution or reciprocation per minute
kg	Kilograms
	Protective Earth

Note: In some situations, failing to observe WARNING notes could result in death or serious personal injury. Be sure to read and observe the safety notes to ensure safe and correct use of the wet stone cutter.

 **CAUTION!**

The following are important notes for products, operation, and maintenance applicable to this stone cutter.

SAFETY INSTRUCTIONS

Read all these instructions before attempting to operate this product.

 **WARNING!**

When using electric tools, basic safety precautions should always be followed to reduce the risk of fire, electric shock, and personal injury, including the following.

► FOR SAFE OPERATION

1. **Keep work area clean**
Cluttered areas and benches invite injuries.
2. **Consider work area environment**
Do not expose power tools to rain. Do not use power tools in damp or wet locations without GFCI protection. Keep work areas well lit. Do not use the tool in presence of flammable liquids or gases.
3. **Guard against electric shock**
Prevent body contact with grounded surfaces. For example: pipes, radiators, ranges, and refrigerator enclosures; use grounded outlets.
4. **Keep children and visitors away**
Do not let visitors contact tool or extension cord. All visitors should be kept away from work area. Keep out of reach of children.
5. **Tool Storage**
When not in use, tools should be stored in a secure dry location. A locked storage area or high shelf out of children's reach is ideal.
6. **Do not force the tool**
It will do the job better and be safer at the rate for which it was intended.
7. **Use the right tool**
Do not force a small tool or attachment to do the job of a heavy-duty tool. Do not use the tool for purposes it is not designed for – (for example – do not use stone cutter for cutting tree limbs or logs.)
8. **Dress properly**
Do not wear loose clothing or jewelry. Items such as these can be caught in moving parts. Rubber gloves and non-skid footwear are recommended when working outdoors. Wear protective hair covering to contain long hair.
9. **Use safety equipment**
Always wear safety glasses and if necessary, a face shield, dust mask and hearing protection.

10. **Do not abuse the electrical cord**
Never carry the tool by the electrical cord or pull it to disconnect from receptacle. Keep the electrical cord away from heat, oil and sharp edges.
11. **Secure workpiece**
Use clamps or a vise to hold workpiece rather than using your hands.
12. **Do not overreach**
Keep proper footing and balance at all times.
13. **Maintain tools with care**
Keep tools sharp and clean for better and safer performance. Follow instructions for lubricating and changing accessories. Inspect the electrical cord periodically and if damaged, have it repaired by authorized service facility. Inspect extension cords periodically and replace if damaged. Keep handles dry, clean and free from oil and grease.
14. **Disconnect tools**
Disconnect the tool from the power supply when not in use, before servicing, and when changing accessories, such as blades, bits, cutters.
15. **Remove adjusting keys and wrenches**
Check to see that keys and adjusting wrenches are removed from the tool before turning it on.
16. **Avoid unintentional starting**
Do not carry a plugged-in tool with finger on switch. Be sure the switch is off when plugging in.
17. **Outdoor use extension cords**
When tool is used outdoors, use only extension cords intended for use outdoors and so marked.
18. **Stay alert**
Use caution and do not operate tool when you are tired or on medication.
19. **Check for damaged parts**
Before using the tool each day, a guard or other part that is damaged should be carefully checked to determine that it will operate properly and perform its intended function. Check for alignment of moving parts, breakage of parts, mounting, and any other conditions that may affect its operation. A guard or other part that is damaged should be properly repaired or replaced by an authorized service center unless otherwise indicated elsewhere in this instruction manual. Have defective switches replaced by authorized service center. Do not use the tool if it cannot be turned on and off by the switch.
20. **Warning**
The use of any other accessory or attachment other than recommended in this instruction manual or the catalog may present a risk of personal injury and could void the warranty.
21. **Only qualified technicians should repair this tool**
This electric tool is manufactured in accordance with the standard safety rules. Only experts may carry out the repair of electric tools; otherwise, it may cause considerable danger for the operator.

ESC-225 OVERVIEW

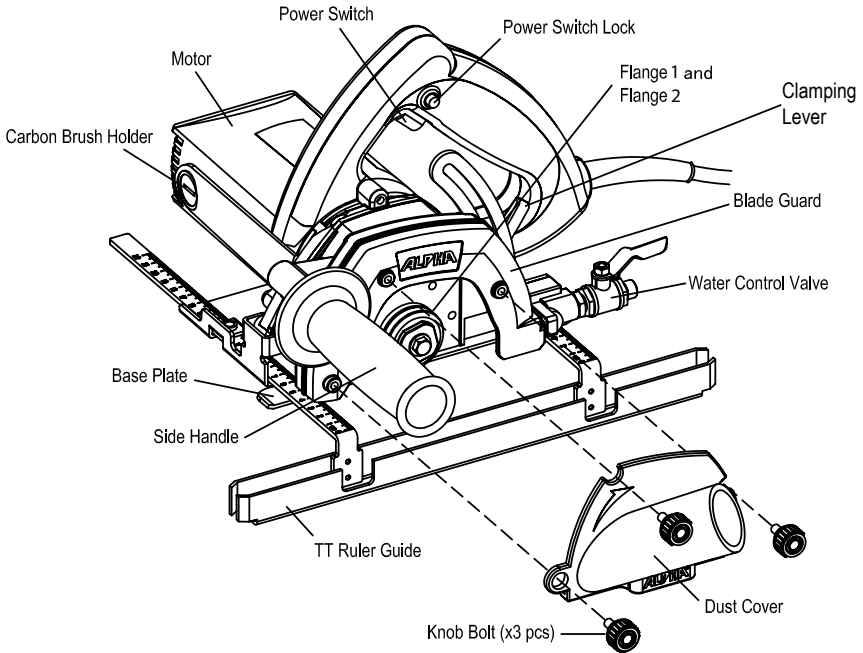

Figure-1

► SPECIFICATIONS

Rating	220 Volts
Amperage	5.5A
Power	1200W
No-load Speed	12,000 RPM
Weight	8.9 lbs/4.0kg
Arbor.....	7/8" / 22.23m
Plug Type	C (220V)
Cord.....	15ft / 4.5m Single-phase
Cutting Disc Diameter	5" / 125mm
Maximum Cutting Depth.....	1-5/8" / 41mm

► **EQUIPMENT INCLUDED**

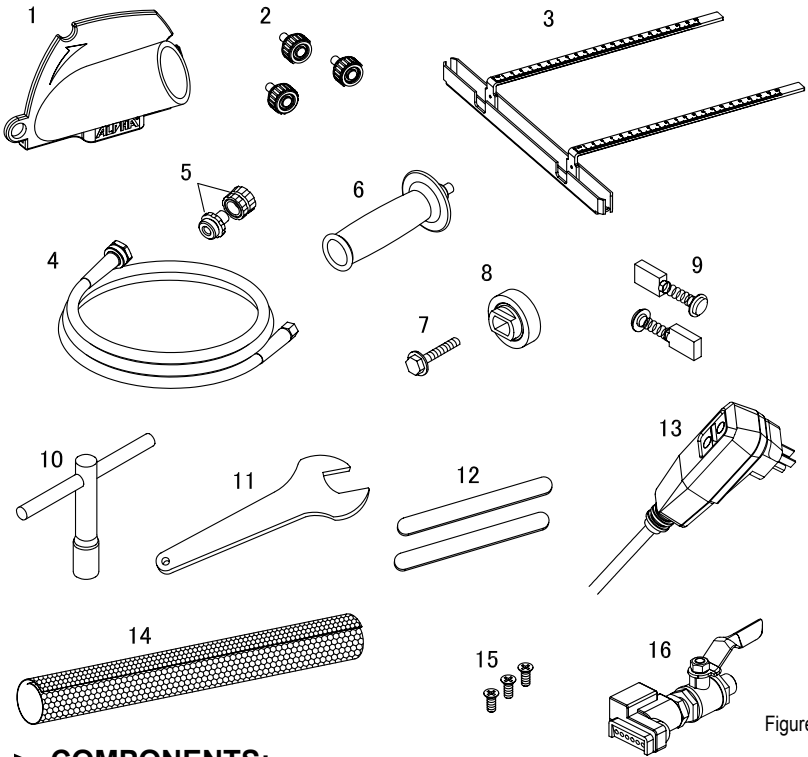

Figure-2

► **COMPONENTS:**

1.	Dust Cover.....	1 pc
2.	Knob Bolt.....	3 pcs
3.	TT Ruler Guide (Reversible).....	1 pc
4.	Water Hose Assembly (15ft / 4.5m).....	1 pc
5.	Quick Connect Adapter.....	1 pc
6.	Side Handle.....	1 pc
7.	Bolt (M6x30-Left).....	1 pc
8.	Flange 3.....	1 pc
9.	Carbon Brush Set.....	1 set
10.	T-Handle Wrench.....	1 pc
11.	Open End Wrench (22mm).....	1 pc
12.	Self-stick Felt Strip Set.....	1 set
13.	GFCI.....	1 pc
14.	EasyOn-EasyOff Sleeve.....	1 pc
15.	SS Flat Head Screw (M4x10).....	3 pcs
16.	Water Valve Assembly.....	1 pc

ADDITIONAL PRECAUTIONS FOR USING THE ELECTRIC WET/DRY STONE CUTTER

In addition to the general safety notes described on the preceding pages, please read and observe the following precautionary notes before using the wet stone cutter.

 **DANGER!**

► INSTRUCTIONS

Alpha Professional Tools® provides the highest quality parts and manufacturing techniques in the manufacture of this tool. In order to obtain the maximum effectiveness and provide the highest degree of safety, it is necessary to review and follow these instructions carefully before using the tool.

► SAFETY ADVICE

- Please note safety instructions on Page 3-5.
- Do not pierce the motor housing as this could damage the double insulation.
- Always remove plug from the outlet before making any changes to the settings or carrying out maintenance.
- Only plug-in when machine is switched off.
- Keep power cable clear from working range of the machine. The power cable should always lead away from you and behind the operating area.
- Before use, check the machine, cable and plug for any damages or material fatigue, only authorized service agents should carry out repairs.
- After switching off, the machine will not idle down immediately. Allow the machine to come to a complete stop before putting it down.
- Always wear safety glasses and ear protection when working with this machine. It is further recommended to wear safety gloves, apron, as well as sturdy non-slipping shoes.
- Only use saw blades whose permitted speed is at least as high as the highest no-load speed of the machine.
- Be sure saw blade fits tool properly and securely. Do not modify the tool to force fit the blade. For example do not remove blade guard.
- Check cutting tools before use. The saw blade must be properly mounted and turn freely. Perform a test run for at least 30 seconds without any load. Do not use damaged, out of round or vibrating cutting tools.
- Immediately switch off the machine in case of considerable vibrations or if other malfunctions occur. Check the machine in order to find out the cause.

- Always use and store the saw blades according to the manufacturer's instructions. The flange bolt must be tightened before starting to work with the machine.
- The work piece must be secured if it is not heavy enough to prevent movement.
- Do not use emery wheel.
- The tool is designed for cutting on horizontal surfaces.

USAGE

This electric wet/dry stone cutter can be used for cutting many different materials, (i.e. tile, concrete, stone, glass or sintered slab). In case of doubt please read the manufacturer's instruction. Do not use this product in anyway other than what is stated for normal use.

ESC-225 ELECTRIC WET/DRY STONE CUTTER OPERATION

► MAIN CONNECTION

Connect only to single-phase AC current supply and only to the main voltage specified on the rating plate. Connection to sockets without ground protection is possible as the appliance features protective insulation to DIN 57/740/ VDE 0740 and CEE 20. Radio suppression complies with the European standard EN 55014.

► SWITCHING ON AND OFF

Intermittent use

Switching on: Press switch trigger

Switching off: Release switch trigger

Continuous use:

Switching on: Press the on/off switch and then the locking button;

Switching off: Press the on/off switch and then release

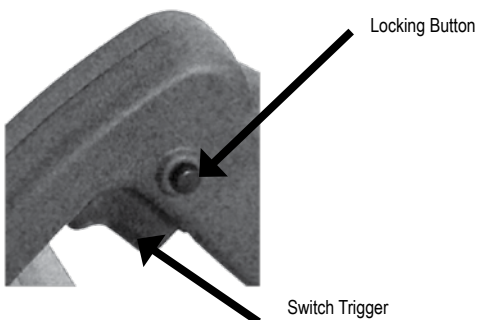

Figure-3

► GROUND FAULT CIRCUIT INTERRUPTER

DANGER!

Do not bypass the GFCI if this condition occurs, a real shock hazard may exist.

WARNING!

If the GFCI fails to trip when the test button is pressed, or fails to reset, the device is defective and should be replaced.

If the GFCI tests properly without a load applied, but trips each time a load is connected, then the load (tool) has a ground fault condition and needs to be repaired or replaced. Do not bypass the GFCI if this condition occurs, a real shock hazard may exist.

CAUTION!

1. The GFCI is a safety device, do not use as an off/on switch.
2. The GFCI on the tool will not protect you if you cut into another current carrying conductor.
3. Do not use where water may enter GFCI case.
4. Do not modify or allow GFCI to be immersed in water.

A Ground Fault Circuit Interrupter (GFCI) is mounted at the end of a power supply cord. The GFCI goes OFF when water enters inside the tool's housing to prevent the operator from receiving electric shocks.

When the GFCI goes OFF, the Reset button pops up. This is the result of water entering the stone cutter housing.

Turn OFF the power switch and blow dry air inside the motor cover through the air vents.

Press the GFCI Reset button. The stone cutter is ready to start working after the reset button is pressed down.

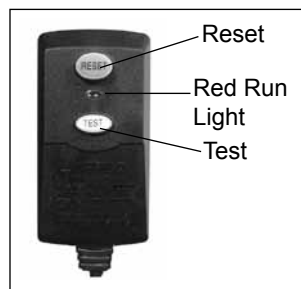

Figure-4

 CAUTION!

1. Do not remove the GFCI.
2. Check items below when the GFCI goes OFF frequently
 - Force applied on the stone cutter
 - Water entered inside the stone cutter, or GFCI
 - Voltage drop due to sharing the same power source in a work area
 - Worn carbon brushes

BEFORE USE

 DANGER!

Before using the machine, check the following items. In particular, check items 1 to 5 before plugging the power supply cord into the power outlet.

1. Check the working voltage.
 - Be sure the voltage specified on the nameplate is the voltage available at the power outlet. If the machine is used with higher voltage than specified, the motor will burnout. Any attempts to do so may damage the tool and/or cause an accident.
2. Make sure the ON/OFF switch is off.
 - If you plug in the power supply cord without realizing that the switch is ON, the machine will start and may cause an accident.
 - Make sure the switch is in the OFF position before plugging the cord in the power outlet.
3. Inspect the protective cover.
 - Do not remove the cover. It will protect you if the saw blade breaks.
 - Be sure to firmly attach the saw blade or any optional accessory.
4. Inspect the saw blade.
 - Check if you have a specified blade.
 - Never use cracked, chipped, or any damaged blades.
 - Follow the procedures specified in the instruction manual to properly attach applicable accessories.

5. Check the power outlet.
 - When the plug of the power supply cord is easily pulled out of the power outlet, the outlet should be replaced. For such tasks, consult an electrician. If the power outlet is used on a continuous basis, it may overheat and cause accidents.
6. Perform test runs.

⚠ WARNING!

1. Before turning the switch ON, make sure the rotating parts are not touching anything. If the switch is turned ON while they are in contact with anything else, the blade may get damaged and it may cause injuries.
2. When a new blade is attached and the switch is turned ON, keep your body well away from the exposed sides of the tool for a moment until the machine reaches its full speed.
3. It is very dangerous to perform cutting operations using cracked, chipped or damaged blades. Before starting cutting operations, keep the tool away from anyone nearby. Be sure to perform a few test runs to check whether there are any abnormalities.

► ABOUT DOUBLE INSULATION

This machine is designed with double insulation. Two insulations are used between the conductor and the outer body of the machine. An Electric Machine with the double insulation highly improves safety from electric shocks. Do not attach or replace unspecified parts and do not assemble incorrectly. This may cause the insulation to malfunction.

► LAWS AND REGULATIONS OF NOISE LEVELS

Please observe local laws and regulations regarding noise level in order to avoid disturbing surrounding areas. Install a soundproof wall if required to comply with the local laws and regulations.

► INSTRUCTIONS FOR INSTALLING THE FELT STRIPS ON THE ESC-225 BASE PLATE

1. Wipe base plate with a clean rag to remove any dirt or residue.
2. Peel off film from the pressure sensitive adhesive on the enclosed felt strips.
3. Place strips on base plate parallel with the blade and press into place.

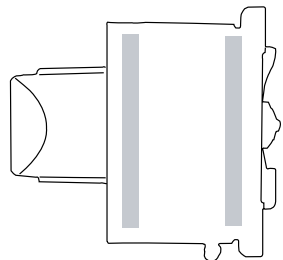

Figure-5

► INSTALLING THE WATER HOSE ASSEMBLY (WET USE)

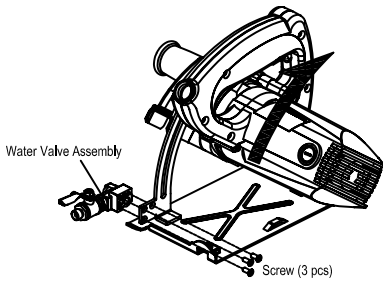

Figure-6

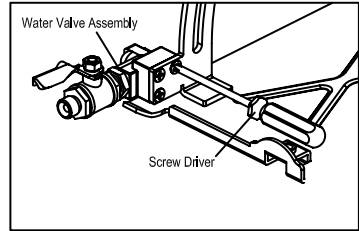

Figure-7

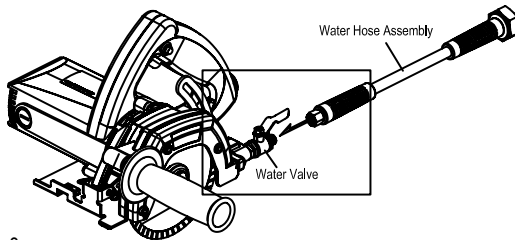
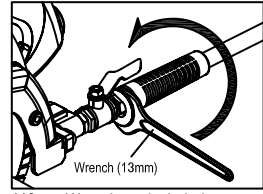

Figure-8



*13mm Wrench not included

Figure-9

► SUPPLYING THE WATER FLOW ⚠

Simply adjust the volume of the water flow by turning the handle on the water valve.

Note: ESC-225 is equipped with a newly designed Aluminum Manifold System that delivers sufficient water jet to cool the cutting edge as well as removing the slurry from the cutting line ahead of the stone cutter. Since water is shooting from the back of stone cutter towards the cutting edge, ample water is provided for any size and kind of blade applicable for the ESC-225.

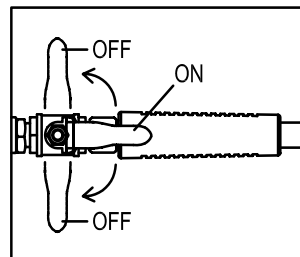
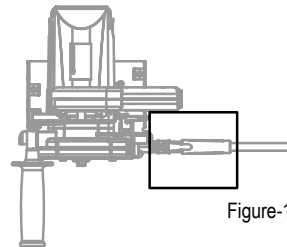

Figure-11

► INSTALLATION OF QUICK CONNECT ADAPTER

1. Secure the Quick Connect Adapter to the Water Hose Assembly.



Figure-12

► INSTALLATION OF EASYON-EASYOFF SLEEVE

1. Wrap the EasyOn-EasyOff sleeve around the Water Hose Assembly and electrical cord.
2. Finish the wrapping procedure until the entire EasyOn-EasyOff Sleeve is secured.



Figure-13

Figure-14

► ADJUSTING THE CUTTING DEPTH

1. Loosen the clamping lever on the depth indicator and move the base plate up or down to the desired cutting depth. Re-tighten the clamping lever to a hand tight condition.

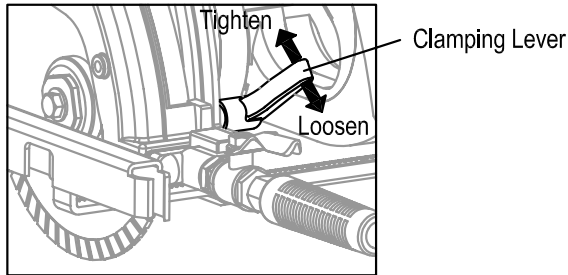
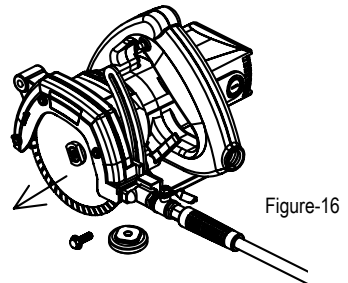
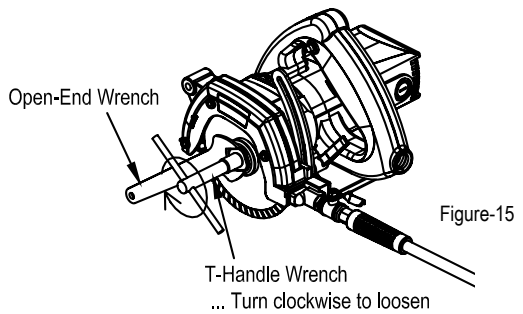

Figure-14

► MOUNTING AND DISMOUNTING THE SAW BLADE ⚠

1. Make certain to switch off the tool and unplug from outlet before assembling or disassembling of the saw blade.
2. Clamp the flange with spanner wrench and loosen bolt by turning the T-handle clockwise to loosen. Disassemble bolt, flange and saw blade.
3. Please follow the same but reverse procedures when reassembling the saw blade.
4. Be sure the direction shown by arrow on the surface of the saw blade is the same as that shown on the blade guard of the tool. Make certain the bolt is firmly tightened.



► **STRAIGHT CUTTING BLADE INSTALLATION (WET USE)**

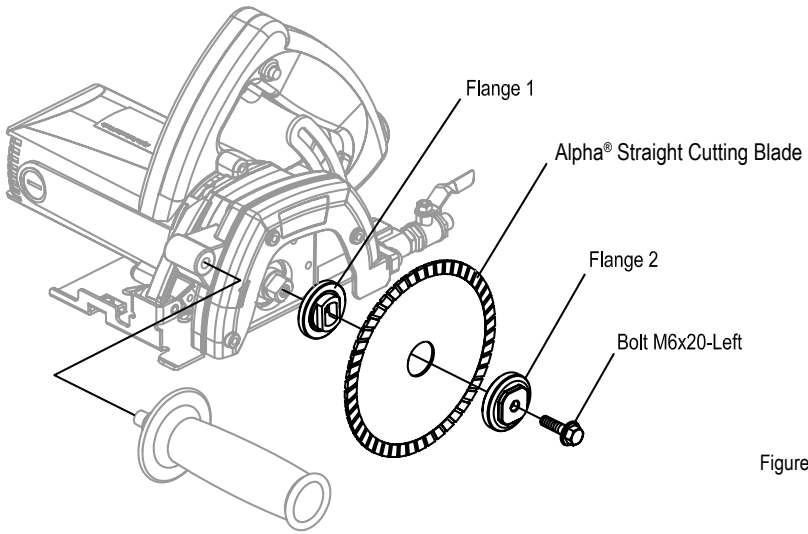

Figure-17

► **CURVE CUTTING BLADE INSTALLATION (WET USE)**

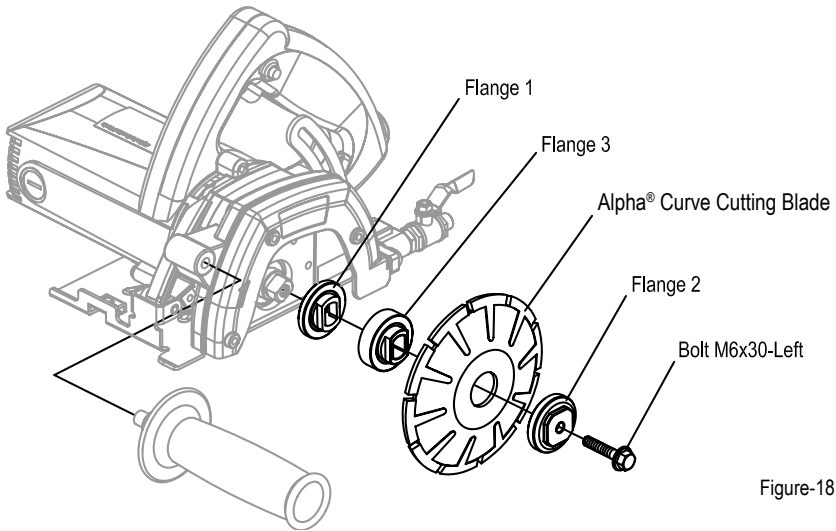

Figure-18

► ATTACHING THE DUST COVER (DRY USE)

After the blade has been attached onto the ESC-225, attach the DUST COVER onto the blade guard using the three Knob Bolts.

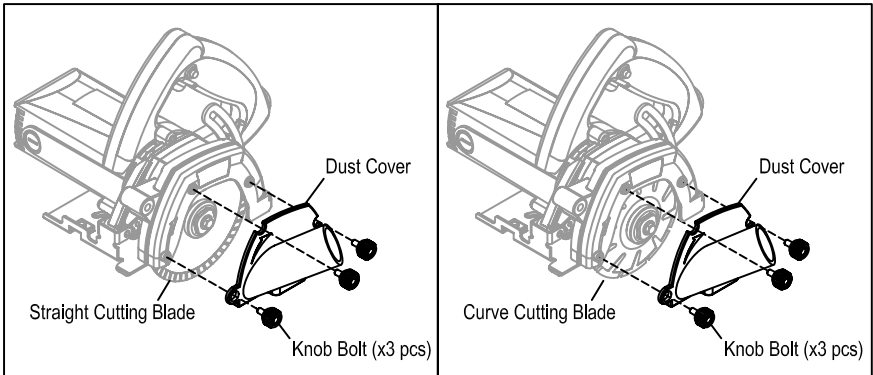

Figure-19

► ATTACHING THE VACUUM HOSE (DRY USE)

The Dust Cover accepts a 1-1/4" hose fitting.

NOTE: Refer to OSHA Standard 1926.1153 – Respirable Crystalline Silica for Specified Exposure Control Methods

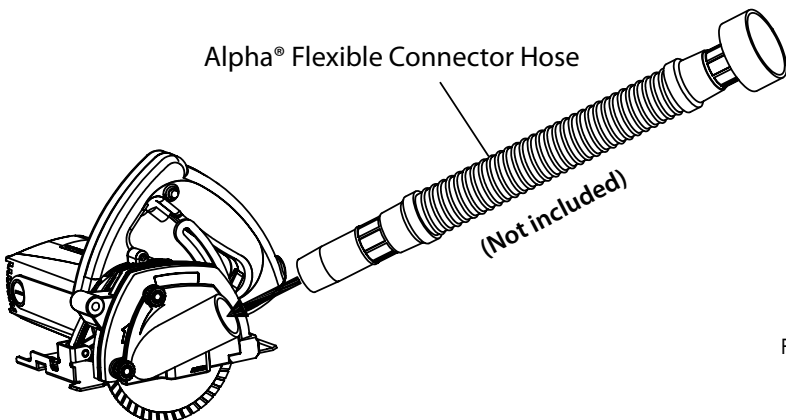

Figure-20

 CAUTION!

Allow the saw blade to do the work, applying excessive forward pressure to the tool will slow down the RPM's and burn up the motor, which voids the limited warranty of the tool.

This tool should only be used for cutting on a horizontal surface. Be sure to follow daily maintenance before and after each use.

► **OPTION 1: FREE-HAND CUTTING**

If you are cutting stone or tile less than 20mm (3/4") thick, the cut can be done in one pass (allow saw blade to do the work).

1. If you are cutting stone or tile more than 20mm (3/4") thick you will need to make the cut in two passes. Adjust the height to 15-20mm for the first pass, then adjust the saw blade below the stone for the second pass (allow the saw blade to do the work).
2. Adjust the amount of water flow to cool the blade and remove the waste, (excessive water flow will get inside the tool and trip the GFCI).
3. Set the base plate on the workpiece and align to the cutting mark on the base plate to cut line on the stone.
4. Press the on/off switch to start the motor and allow the tool to attain full speed before starting to cut.
5. Advance the tool slowly allowing the blade to do the work, keeping the base plate flat on the stone and the cut mark in line with your cut line.
6. Slow the cutting speed for the last 1/2" to prevent the tile or stone from chipping.

► **OPTION 2: USING THE TT RULER GUIDE**

Install the ruler on the ESC-225 by inserting the arms into the appropriate slots on the base plate and tightening the screws to secure the ruler in place.

1. When using the edge of the stone as your guide, install the ruler so that it is below the base plate (Figure-21). Measure the distance from the edge to the intended cut and use this measurement to set the ruler at the proper distance.

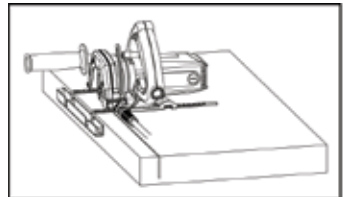

Figure-21

2. When using a straight edge as a guide, install the ruler so that it is above the base plate (Figure-22). Measure the distance from the straight edge to the intended cut and use it to set the ruler at the proper distance. When cutting, simply keep the ruler in contact with the straight edge while maintaining even cutting pressure and the cuts will be straight.



Figure-22

► OPTION 3: USING THE CARRIAGE ASSEMBLY AND GUIDE RAIL (WET OR DRY)

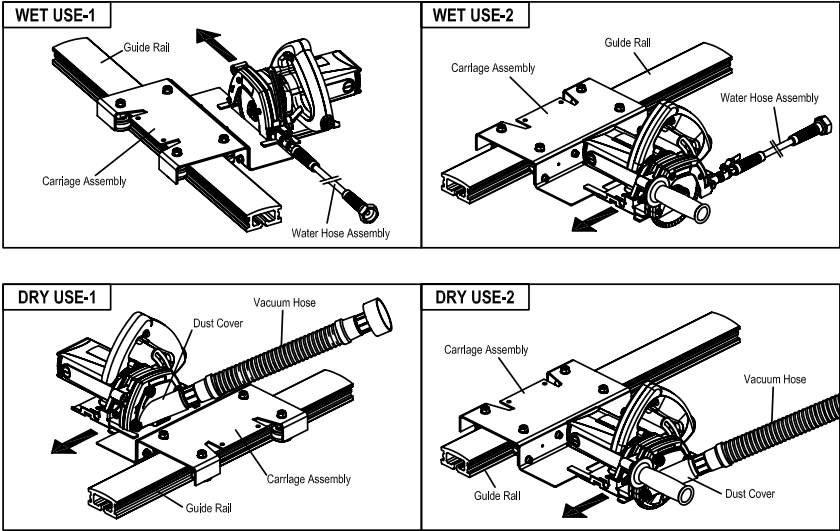

Figure-23

Note: Refer to OSHA Standard 1926.1153 - Respirable Crystalline Silica for Specified Exposure Control Methods.

► CURVE CUTTING APPLICATION

When cutting the curved line, remove the TT ruler guide and cut free-hand.

- Step 1. Score along the cutting line (1/3 width of stone).
- Step 2. Step-cut along scored line (2/3 width of stone).
- Step 3. Plunge cut all the way to make full contact between bottom plate and stone, then maintain even cutting pressure to follow curved cut line.

STEP CUTTING

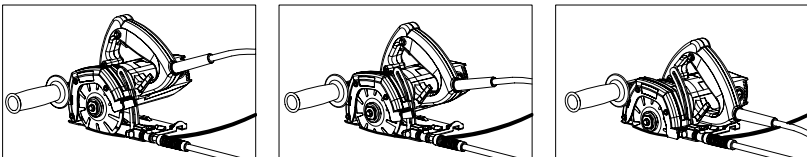

STEP 1

STEP 2

STEP 3

Figure-24

 **WARNING!**

1. Support the sink cutout area prior to cutting, otherwise the cutout piece may drop to the floor at the end of the cutting application.
2. Use the Alpha® Contour Cutting blade only. This Application with inferior blades may cause damage to the stone cutter.
3. Do not force the stone cutter during the cutting application. Allow the blade to cut at its own pace. Excessive force may damage the stone cutter

BLADE INSPECTION, INSTALLATION, AND REMOVAL

 **DANGER!**

Be sure to unplug the power cord from the outlet before attaching or removing the saw blade from the tool. Accidental starting of the motor may cause bodily injury.

 **WARNING!**

Be sure to securely tighten the flange assembly and all loose screws before testing the unit. Please allow the saw blade to do the work.

Only use saw blades with 7/8" arbors and maximum speed rating equal to or higher than the name plate of RPM of the tool.

1. To remove the flange bolt from the spindle, hold Flange 1 in position with the 22mm spanner wrench while turning the flange bolt with the T-handle wrench in a clockwise rotation until it is removed.
2. With the flange bolt removed, remove Flange 2 off of Flange 1.
3. Install the 7/8" arbor saw blade onto Flange 1 with the arrow on the blade pointing in the same direction as the arrow on the blade guard (blade will turn in a clockwise rotation). The blade should fit tightly on the Flange 1.
4. Reinstall Flange 2 and then the flange bolt, turning counter-clockwise to install. Once flange bolt is hand tightened, use the 22mm spanner wrench to hold Flange 2 in place and finish tightening the flange bolt with the T-handle wrench.

ESC-225 MAINTENANCE

► DAILY

1. Before daily start-up, inspect tool, power cord, GFCI, and Saw Blade, looking for chips and cracks.
2. If damage has occurred, repair affected areas before use.
3. Connect the tool to the correct power source and test the Ground Fault Circuit Interrupter (GFCI) before using the tool. Push the red RESET button and confirm that the red run light is on. Push the yellow TEST button and confirm that the red run light is off, push the red RESET button to use the tool.
4. After daily use of the tool, clean and blow off the exterior of tool and around air intake vents to remove any standing water or stone dust on the field coil, carbon brushes, and bearings. Failure to do this will shorten the life of your tool, and could void your warranty.

► PERIODIC

Preventive maintenance performed by unauthorized personnel may result in misplacing of internal wires and/or components which voids the warranty and could cause serious hazards. We recommend that tool service and repairs not covered in the manual be performed by an Alpha® Repair Center.

Periodic maintenance is done to check the tool and to minimize down time. These checks are done based on hours of operation and operating conditions. Operating condition can vary depending on the work surface and job being performed. If the tool is not used for a long period of time the carbon brushes should be checked and the commutator cleaned, before putting the tool back into operation.

► BEARINGS AND GEARS

To minimize your tool's downtime and expensive repairs, it is recommended to send the tool back to an Alpha® Repair Center after about 300 to 400 hours of operation, or every second carbon brush change. The bearings should be replaced and the gears should be checked. If your tool starts to sound different, this could be an indication of a worn bearing. Continuing to use the tool in this condition could result in overheating or motor failure.

► REPLACING AND CHECKING THE CARBON BRUSHES

In order to keep the tool running correctly, the carbon brushes need to be checked after every one hundred hours (100 hrs) of use. Carbon brushes wear out over time based on the tool's usage. If a carbon brush is worn out, it may cause the motor to malfunction or fail to run. The carbon brushes should be replaced when they are worn down to a quarter of an inch (1/4") in size.

 **DANGER!**

Be sure to unplug the power cord from the outlet before assembling or disassembling the tool. Accidental starting of the motor may cause bodily injury.

► CARBON BRUSH REPLACEMENT

1. Locate the Carbon Brush Caps at the rear of the motor (one on each side).

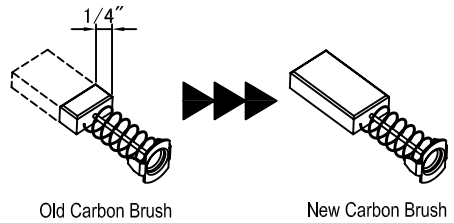

2. Unscrew the caps completely until carbon brush releases from brush holder.

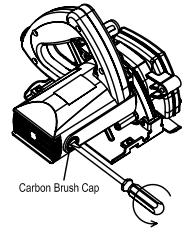

Figure-25

3. Check the carbon brush for wear. Replace if worn down to a 1/4" or if spring is damaged.

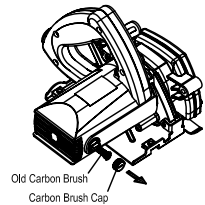

Figure-26

4. Install the new carbon brush with the proper alignment into the brush holder and then reinstall the caps.

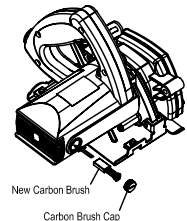
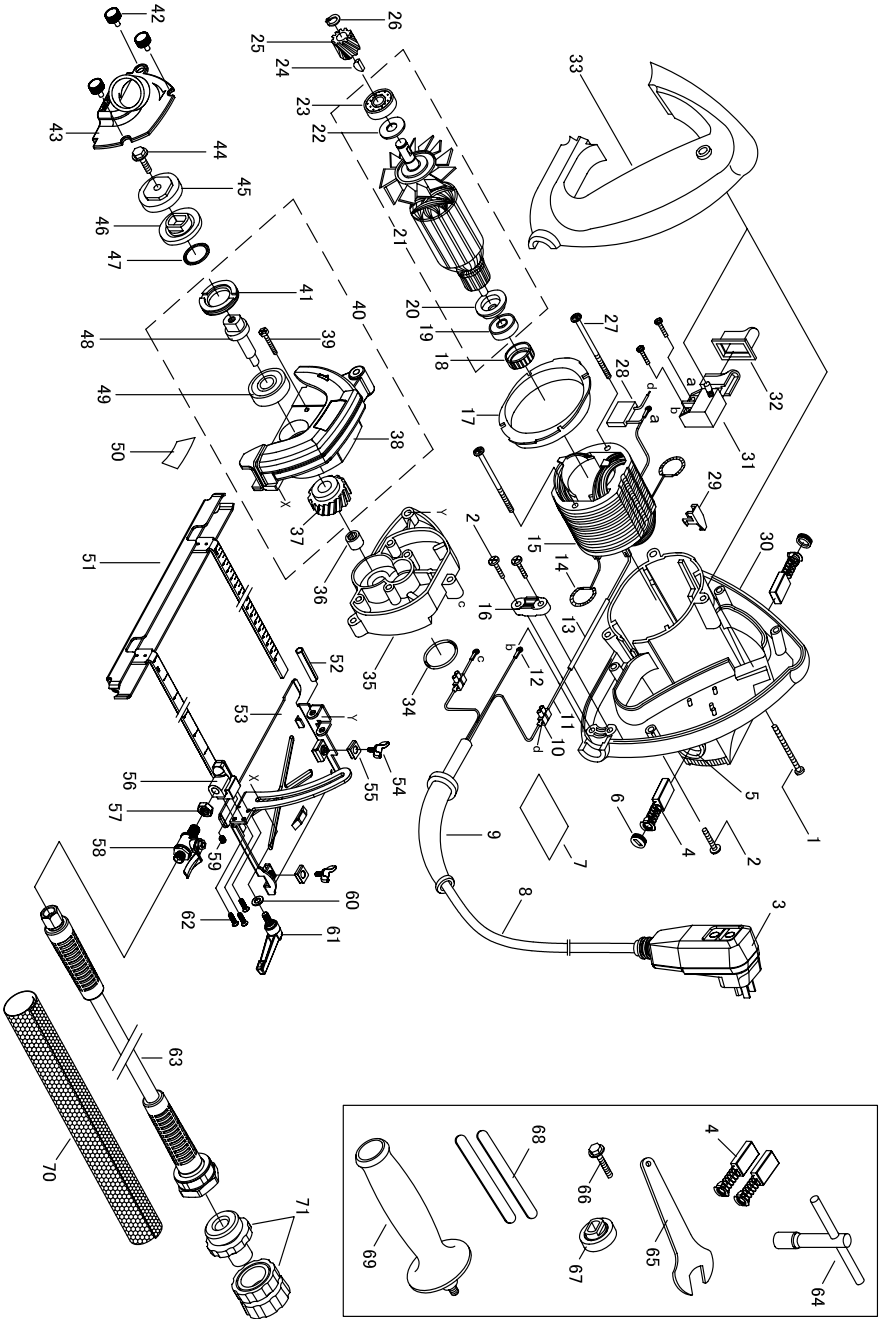

Figure-27

ALPHA® ESC-225 - 5" ELECTRIC WET/DRY STONE CUTTER SCHEMATIC



ALPHA® ESC-225 - 5" ELECTRIC WET/DRY STONE CUTTER PARTS LIST

DRAWING NO.	PART NO.	DESCRIPTION	QUANTITY
1	133080	Screw (M5x40)	3
2	133031	Self-tapping Screw 3.9x19	9
3	133292	GFCI 220V	1
4	133033	Carbon Brush (2 pc set)	2
5	133031	Brush Holder	2
6	133032	Brush Cap	2
7	133398	Rated Plate 220V	1
8	133403	Cable 220V (15ft./5m)	1
9	133047	Cable Sleeve	1
10	130618	Block Terminal	2
11	133039	Field Line	1
12	133282	Wire Terminal RV2-4	1
13	133042	Insulation Pipe	2
14	133034	Brush Terminal Assembly	2
15	133436	Field Coil 110V	1
16	133086	Cable Clamp	1
17	133030	Air Bridge	1
18	133028	Bearing Sleeve	1
19	133025	Bearing 608-2RZ	1
20	133024	Insulation Disc	1
21	133012	Armature 220V	1
22	133026	Bearing Cover	1
23	133027	Bearing 629-2RZ	1
24	133050	Woodruff Key	1
25	133048	Gear (Small)	1
26	133051	Snap Ring M8	1
27	133029	Self-tapping Screw 4.8x65	2
28	133392	Condenser Assembly	1
29	133041	Cable Clip	2
30	133628	Rear Motor Housing	1
31	133043	Switch (With Screw)	1
32	133044	Rubber Switch Cover	1
33	133635	Handle	1
34	133067	O-Ring (25.5x2)	1
35	133255	Gear Box (Silver)	1
36	133066	Needle Bearing BK 0810	1

ALPHA® ESC-225 - 5" ELECTRIC WET/DRY STONE CUTTER PARTS LIST

DRAWING NO.	PART NO.	DESCRIPTION	QUANTITY
37	133058	Gear (Big)	1
38	133371	Blade Guard	1
39	133079	Screw (M4x25)	4
40	133399	Spindle Assembly	1
41	133060	Screw Cap	1
42	133771	Knob Bolt (M5x10)	3
43	133770	Dust Cover	1
44	133464	Screw (M6x20-left)	1
45	133419	Flange-2	1
46	133440	Flange-1	1
47	133062	O-Ring (18x2.5)	1
48	133057	Spindle	1
49	133053	Bearing 6201-2RS	1
50	133408	Brand Label ESC-224	1
51	133416	TT Ruler Guide	1
52	133085	Pin (6x28)	1
53	133374	Base Plate Assembly	1
54	133084	Wing Screw	1
55	133269	Washer For Ruler	2
56	133373	Aluminum Manifold	1
57	133379	Hexagon Nut (M10xP1.0)	1
58	133378	Water Control Valve	1
59	133402	Pipe Plug (6.5L)	1
60	133071	Flat Washer M6	1
61	133375	Lock Handle (M6x12)	1
62	133382	SS Flat Head Screw (M4x10)	3
63	210129	Water Hose Assembly (15ft./5m)	1
64	133098	T-Handle Wrench	1
65	133097	Open End Wrench (22mm)	1
66	133463	Screw (M6x30-left)	1
67	133432	Flange-3	1
68	133369	Felt Strip Set	1
69	801086	Side Handle	1
70	210124	Memory Wrap (3ft./1m)	1
71	133773	Quick Connect Adapter	1

EC DECLARATION OF CONFORMITY

Name of Manufacturer: Alpha Professional Tools®

Address of Manufacturer: 103 Bauer Drive
Oakland, NJ 07436
USA

Herewith declares that:

ELECTRIC HAND TOOL: "Electric Wet/Dry Stone Cutter"

Make: Alpha Professional Tools®
Type: ESC-225

-Does comply with the provisions of EMC 2004/108/EC, the Low Voltage Directive 2006/95/EC and Machinery Directive 2006/42/EC .

And furthermore declares that:

-The following (parts/clauses of) harmonized standards have been applied:
EN61000-3-3/+A2:2005, EN55014-1:2006, EN55014-2/A1:2001, EN61003-3-11:2006, EN60745-1:2009.

Year of affix CE Marking: 2018
Oakland, New Jersey USA

Jan / 11 .2018



Nao Takahashi
(President)

► WARRANTY

Limited Warranty of Alpha® Electric Wet/Dry Stone Cutter (ESC-225) for USA and Canada ONLY!

Alpha Professional Tools® warrants this product against defects in material and workmanship for a period of one year from the date of original retail purchase (proof of purchase required). If Alpha Professional Tools® receives notice of such defects during the warranty period, our obligation assumed under this warranty is limited to the repair or replacement of parts, without charge. This warranty does not apply to Alpha® accessories. Returns within the warranty period should be sent in freight prepaid to an Authorized Warranty Service Center.

The warranty does not apply in situations where:

- The tool has been misused, abused or improperly maintained
- Alterations or repairs were made by others
- Repairs due to normal wear and tear

Some States do not allow limitations on how long an implied warranty lasts or the exclusion or limitation of incidental or consequential damages, so the above limitation may not apply. This warranty gives you specific legal rights and you may also have other rights which vary from state to state.

For Warranty Claims: Send complete tool with all your information and details of the problem to an Authorized Warranty Repair Center, transportation prepaid. Do not send tool accessories.

NOTE: Any tools purchased through an unauthorized distributor are not covered under warranty.

PRODUCT REGISTRATION CARD

Model No.: **ESC-225**

Serial No. _____

Company Name: _____

Name: _____

Address: _____

City: _____ State: _____ Zip: _____

Telephone: _____

Purchase Date: _____

Dealer's Name: _____

Note: Serial & Model Number must be included for proper registration.



Alpha Professional Tools®

(800) 648-7229



Register online at:

www.alpha-tools.com/productregistration.aspx

Mail or Fax to:

Alpha Professional Tools®

103 Bauer Drive, Oakland, NJ 07436

Fax: 800-286-0114



103 Bauer Drive, Oakland, NJ 07436 • 800-648-7229 • Fax: 800-286-0114
www.alpha-tools.com

Copyright © 2018 Alpha Professional Tools. All rights reserved.

07/2018